

Godfrey Hirst

F L O O R S

# TIMBER Timber Installation Instructions

## Please read the following before starting installation

- Start with a visual inspection of all boards before installation. Once installed, the products are considered accepted of grade and standard.
- Timber flooring is a natural product and will have unique colour and variation of grain structure, which are not considered to be flaws. This variation adds to the beauty and the charm of the product. Godfrey Hirst Timber products are manufactured in accordance with accepted manufacturing standards, with a defect tolerance not exceeding 5%. The defect may be a natural or manufacturing defect.
- Never install defective product. Product should always be inspected prior to installation and any visual defects in the product should not be installed. If the entire product has visual defects, contact the dealer.
- The use of any filler, putty or stain to correct any defects during installation should be accepted as normal practice.
- It is normally deemed best practice for the product to be installed after all other construction work has finished.

## Please read the following instructions thoroughly and carefully before laying the floor

- Packs of boards must be stored in a cool, shaded and protected dry place (ambient temperature of 18 – 25°C and relative humidity of 30-70%). Do not open the packs until day of installation to avoid moisture pickup in the board.
- ***Each board should be carefully checked prior to installation.*** Never install any damaged boards. Inspect each board as you install them.
- Mix and match between packs to get better colour matching on your floor. Always work out of several different packs alternately for installation.
- **The surface-temperature of the sub-floor, at the time of installation, should be at least 15°C but never exceed 27°C, with the relative humidity not exceeding 70%.**
- The subfloor should be dry, clean, level and free of any cracks.
- Irregularities on the subfloor should not exceed 3 mm every 1 meter in all directions.
- If there is need to level concrete subfloor, a cement-based floor-filler, or an appropriate grinding machine should be used.
- The installation of a 2mm moisture barrier, such as Godfrey Hirst Arriba™ or Arriba Plus™ Underlay (or equivalent) is recommended. Never overlap edges of the underlay. Tape underlay edges with appropriate adhesive tape.



**Fig 1.** Ensure that the subfloor is clean and level. Using a 1 metre straightedge, the subfloor level should not exceed 3mm over 1 metre in any direction. Uneven subfloors will effect the performance of the product and may lead to product failure. Uneven floors can also cause noise. Floors can be levelled with a self leveling compound and high spots can be ground/sanded. The product can be installed over well adhered and level vinyl, cork, ceramic tiles and timber floorcoverings (never over other floating floorcoverings) The product cannot be installed over carpet and or carpet underlay.

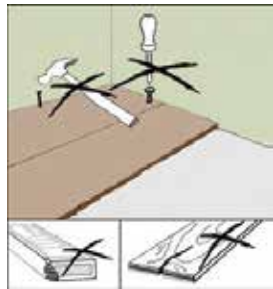

**Fig 3.** Godfrey Hirst Timber is recommended to be installed as a floating or glue down (using a suitable adhesive) system. It is not recommend to nail or screw the product to the sub floor.

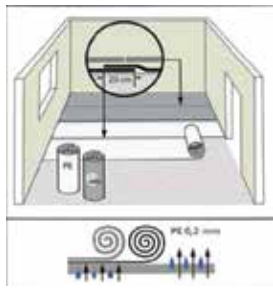

**Fig 5.** Never overlap underlay edges. Joins should be taped with an adhesive tape. When planning the installation remember to not place a join in the product within 20 cm of a join in the underlay.

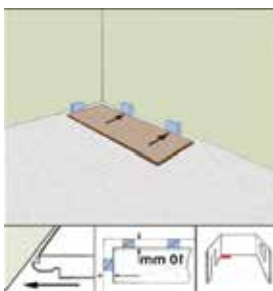

**Fig 7.** Starting from left to right place the first board in position, with spacers 10mm from wall.

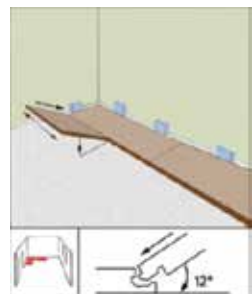

**Fig 9.** Start the next row with a board cut no smaller than 400mm. Click the side profile into the first row.

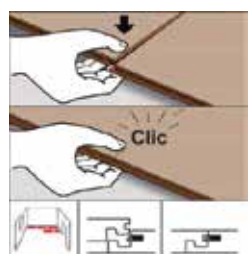

**Fig 11.** Place one hand under the board and a thumb on top, pressing until you hear a click.

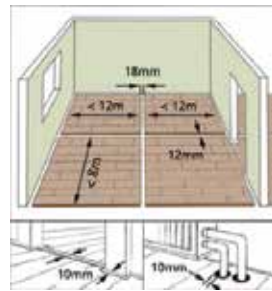
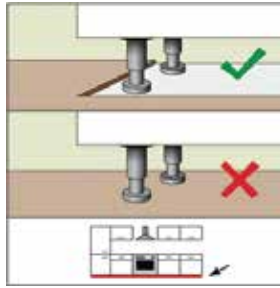

**Fig 2.** Floating floors will expand and contract as a whole. It is recommended areas over 12 metres in length and 8 metres in width be compartmentalised. This can be achieved by the use of expansion trims. This must be discussed with the dealer and installer before commencement of the installation. An expansion gap of no less than 10mm must be left around the perimeter and fixed objects.

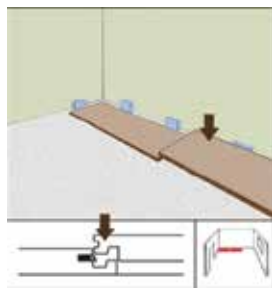

**Fig 4.** Required for installation

- pencil
- saw
- spacers
- measuring tape
- 2mm closed cell moisture barrier underlay



**Fig 6.** Never place kitchens or other fixed items on the product as this may cause product failure. The illustration shows the correct procedure to installing such objects.



**Fig 8.** Place the second board into the first board and firmly press the end lock till you hear a click.

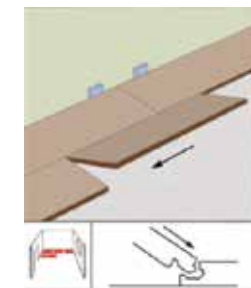

**Fig 10.** Place the second board of row two into the side profile of the first row. Slide to the end lock.



**Fig 12.** Cut a board to fill in row one as illustrated , and place the other end of that board to start row three. Make sure that it still has its locking system on.

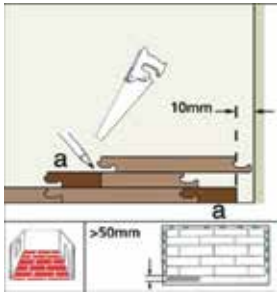

**Fig 13.** Board **a** in diagram is placed onto the last row of installed boards. Then another board is placed over the top of board **a**. Position this board, taking into consideration the locking system and expansion gap and mark board **a** as illustrated. Then cut board **a** to fit last row. Board **a** must not be smaller than 50mm.

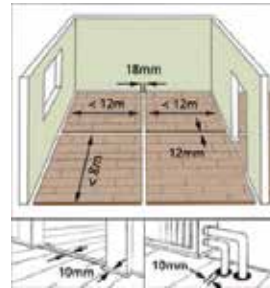

**Fig 14.** Architraves (doorways) can be installed with a 10mm expansion gap. Alternatively, the architrave can be undercut a little higher than the thickness of the board. Adequate expansion must still be left.

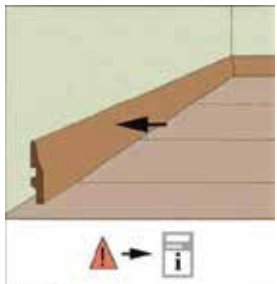

**Fig 15.** Skirting, scotia or quad can be installed around walls. This must not be fixed with nails or screws to the boards and only to the wall. Carefully install skirting, scotia or quad so that it is not pushing down on the boards. This will affect the floors ability to expand and contract and may lead to product failure.

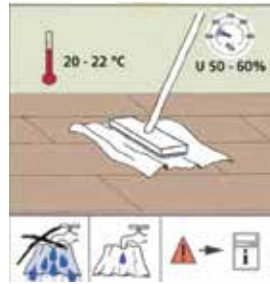

**Fig 16.** Never clean with a excessively wet mop. Clean with a damp well wrung out mop. The use of steam mops are not recommended and may cause product failure.

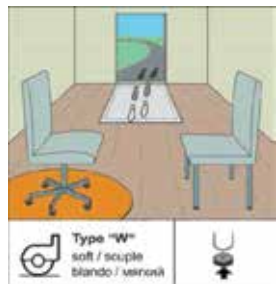

**Fig 17.** Always place walk off mats in doorways and protect the boards by fitting rubber or fabric protectors on furniture. Roller castor chairs should be on a protective mat.

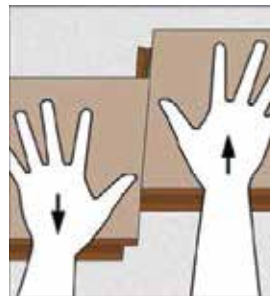

**Fig 18.** Remove the boards by unclipping the side profile. Then simply slide the end profile backwards